

Genfo Water Backpacks

The Cadillac of water backpacks

GENFO45

- The C&S original Water Back Pack now has shoulder pads
- 5 gallon capacity (only 4 minutes to completely discharge)
- Industrial Quick Connects for quick fill or stowing the pump wand.
- Double action Chrome Plated Brass hand pump
- Effective stream distance of up to 24 feet (max 30 feet)
- Large 4" polymer cap for easy refill
- Durable polymer and textile collapsible reservoir
- Thermo Welded seams for strength and durability
- Reinforced at the top and bottom for extra durability
- Flexible Horizontal Baffle inside to reduce shifting water weight
- Nozzle tip adjusts from straight stream to spray pattern
- Easy 'No Tool' maintenance

Wt: 5 lbs.



GENFO-PRO

- The new more comfortable and versatile Water backpack
- 5 gallon capacity (only 4 minutes to completely discharge)
- Industrial Quick Connects for quick fill or stowing the pump wand.
- Double action Chrome Plated Brass hand pump
- Effective stream distance of up to 24 feet (max 30 feet)
- Large 4" polymer cap with Screen for easy refill
- Durable Textile pack with separate replaceable reservoir
- Thermo Welded seams for strength and durability
- Padded Shoulder straps and waist belt
- Storage pouch for foam concentrate
- Straps to hold the wand and/or hold a tool
- Nozzle tip adjusts from straight stream to spray pattern
- Easy 'No Tool' maintenance

Wt: 5 lbs.

GENFO45 FOAM TUBE

- Foam attachment option is quick to install or remove and aspirates the foam solution making finished foam

Wt: 1 lb.

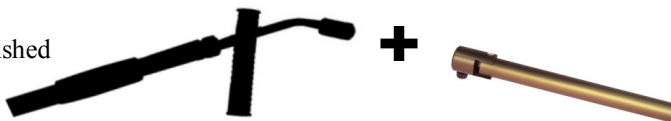

C&S Supply
QUALITY AFFORDABLE PRODUCTS

3842 Redman Dr. Fort Collins CO 80524
Phone: 888-663-4966 - Fax: 970-663-4966 - www.cssupplyinc.com

DANGER

PLEASE BE RESPONSIBLE!
PLEASE BE CAREFUL!

THE USER OF THIS EQUIPMENT IS
PERSONALLY RESPONSIBLE FOR THE
FOLLOWING:

1. You need to know and understand that Fire-fighting and Emergency response is dangerous and proper training is needed.
2. You need to be physically fit and skillful in the use of any equipment that you may need to use.
3. You need to know that your equipment is in proper working order.
4. You need to know carelessness or negligence may result in injury or death.

PLEASE BE RESPONSIBLE!
PLEASE BE CAREFUL!

Maintenance:

- Test all equipment before putting into service.
- Clean unit by flushing with water after use.
- Use non-detergent soap to clean dirt from the exterior to reduce wear .
- Periodically service the unit or have your fire equipment dealer service it.

**For parts/repairs contact your
fire equipment dealer.**

Dealer name: _____

Genfo Wand Parts

Ref.	Name	Special Note
A	Spray Tip	
B	Inner Wand	(all B parts incl.)
B-1	Genfo O-Ring	(Same as B-4,7)
B-2	Grease Cap	
B-3	Wand Nut	
B-4	Retainer Pin	
B-5	Genfo O-Ring	(Same as B-1)
B-6	Check Ball	
B-7	Check Ball Housing	
B-8	Genfo O-ring	(Same as B-1)
C	Outer Wand	
D	GENFO HOSE	(All parts D incl.)
D-1	Retainer Pin	
D-2	Spring Retainer	
D-3	Check Ball	
D-4	Spring	
D-5	GENFO-QCHOSECLAMP	
D-6	GENFO-QCMALE	
D-7	GENFO-QCFEMALE	

(Purchasable Replacement part numbers)

E	GENFO BLADDER
E-1	GENFO FILL CAP
E-2	GENFO HARNESS
A,B1	GENFO TIP
A,B,C,D	GENFO HOSE WAND
D-5,6,7	GENFO-QCKIT
A,B1-8,D1-7,E1-3	VRK- GENFO45

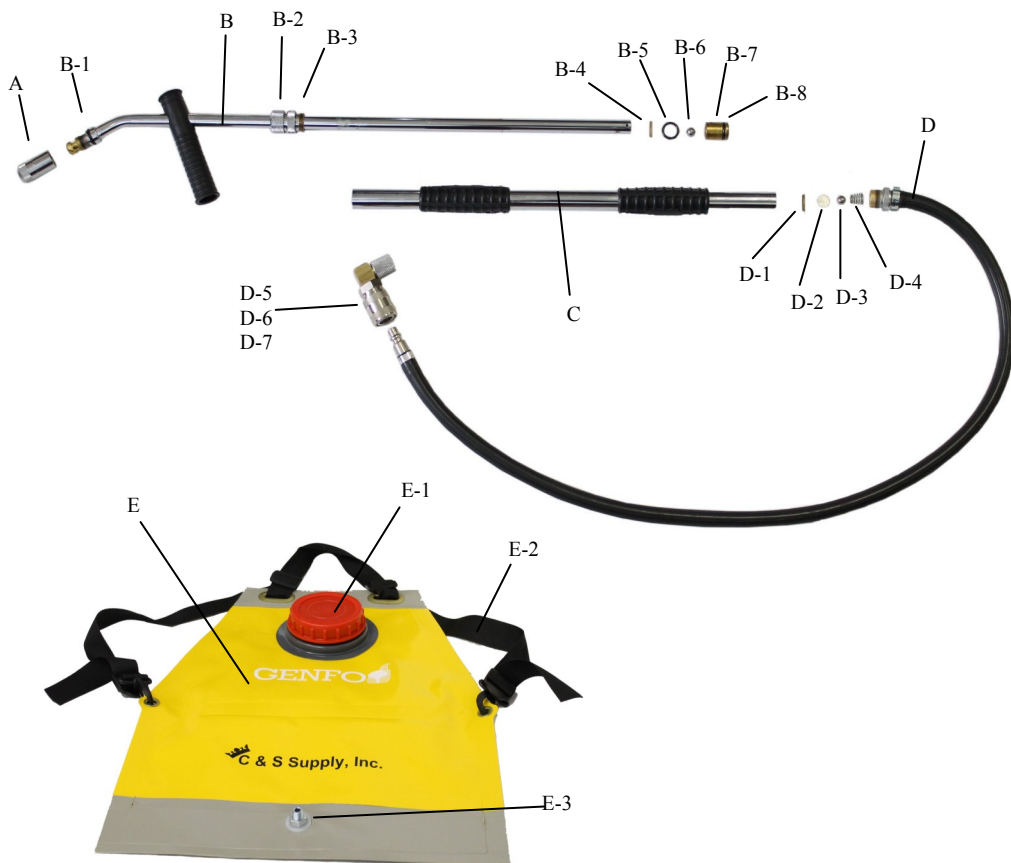

C & S Supply
QUALITY AFFORDABLE PRODUCTS

3842 Redman Dr. Fort Collins CO 80524
Phone: 888-663-4966 - Fax:970-663-4966 - www.cssupplyinc.com